

Push to Connect Fitting - Reducer Y (PW)

Inch Tube Specifications (Refer to Diagram Below)

MODEL	ΦD		L	E	B1	B2	C	P1	ORIFICE
	D1	D2							
PW 3/16-5/32	3/16	5/32	36.6	22	12.4	15.4	3.3	13.0	3.3
PW 1/4-5/32	1/4	5/32	36.6	22	12.4	15.4	3.3	13.0	3.3
PW 1/4-3/16		3/16							4.0
PW 5/16-1/4	5/16	1/4	38.2	26	14.3	16.4	3.3	14.6	5.0
PW 3/8-1/4	3/8	1/4	45.5	30	18.2	12.4	4.2	18.0	5.0
PW 3/8-5/16		5/16				18.3			7.0
PW 1/2-3/8	1/2	3/8	52.7	36	19.0	22.2	4.2	20.0	7.0

**All Whole Numbers = Millimeter (MM)

Diagram - Reducer Y (PW)

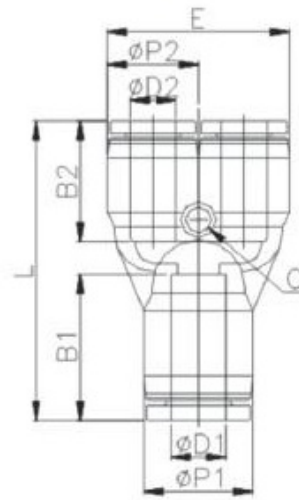

Metric Tube Specifications (Refer to Diagram Above)

MODEL	ΦD		L	E	B1	B2	C	P1	ORIFICE
	D1	D2							
PW 06-04	6	4	36.6	22	12.4	15.4	3.3	13	3.3
PW 08-06	8	6	38.2	26	14.3	16.4	3.3	14.6	4.0
PW 10-08	10	8	45.5	30	18.2	18.3	4.2	18	5.0
PW 12-10	12	10	52.7	36	19	22.2	4.2	20	6.4

**All Whole Numbers = Millimeter (MM)