

Push to Connect Fitting - Bulkhead Union (PMM)

Inch Tube Specifications (Refer to Diagram Below)

MODEL	ΦD	T	L	E	H	B	ORIFICE
PMM-5/32	5/32	M12*P1	32	3.5	14	12.5	3
PMM-3/16	3/16	M14*P1	32	3.5	14	12.5	4
PMM-1/4	1/4	M14*P1	34	4	17	13.3	5
PMM-5/16	5/16	M16*P1	36.2	4.5	19	14.4	7
PMM-3/8	3/8	M20*P1	45.6	5	24	18.8	8
PMM-1/2	1/2	M22*P1	47.4	5	27	19	11

**All Whole Numbers = Millimeter (MM)

Diagram - Bulkhead Union (PMM)

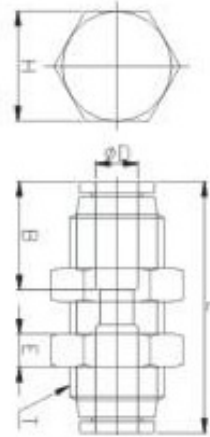

Metric Tube Specifications (Refer to Diagram Above)

MODEL	ΦD	T	L	H	B	ORIFICE
PMM-04	4	M12*P1	32	14	12.5	3
PMM-06	6	M14*P1	34	17	13.3	5
PMM-08	8	M16*P1	36.2	19	14.4	6
PMM-10	10	M20*P1	45.6	24	18.8	8
PMM-12	12	M22*P1	47.4	27	19	10

**All Whole Numbers = Millimeter (MM)