

Push to Connect Fitting - Plug-In Elbow (PLJ)

Inch Tube Specifications (Refer to Diagram Below)

MODEL	ΦD1	ΦD2	ΦP	L	E	A	B	ORIFICE
PLJ 5/32	5/32	5/32	11	32	23.5	15.4	15.4	2.0
PLJ 3/16	3/16	3/16	11	32	23.5	15.4	15.4	2.6
PLJ 1/4	1/4	1/4	13	36	25.4	16.4	16.4	4.2
PLJ 5/16	5/16	5/16	15	40	30.4	18.3	18.3	6.0
PLJ 3/8	3/8	3/8	18	45	36.8	22.2	22.2	7.0
PLJ 1/2	1/2	1/2	21	54.7	39.4	23	23	9.0

**All Whole Numbers = Millimeter (MM)

Diagram - Plug-In Elbow (PLJ)

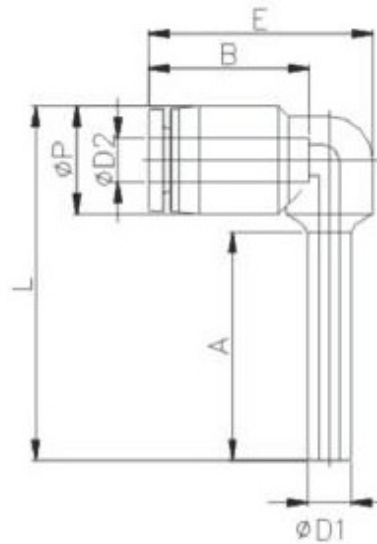

Metric Tube Specifications (Refer to Diagram Above)

MODEL	ΦD1	ΦD2	ΦP	E	L	B	ORIFICE
PLJ 04	4	4	11	23.5	32	15.4	2
PLJ 06	6	6	13	25.4	36	16.4	4
PLJ 08	8	8	15	30.4	40	18.3	6
PLJ 10	10	10	18	36.8	45	22.2	7
PLJ 12	12	12	20	39.4	54.7	23	9

**All Whole Numbers = Millimeter (MM)