

Push to Connect Composite Air Fitting - Female Elbow (PLF)

Inch Tube - NPT Thread Specifications (Refer to Diagram Below)

MODEL	ΦD	ΦP	T	L	E	A	B	H _(HEX)	ORIFICE
PLF-5/32-U10	5/32	11	UNF 10/32	24.7	23.5	5.5	15	7/16	2.5
PLF-5/32-N1			NPT 1/8	28.7		9		9/16	
PLF-5/32-N2			NPT 1/4	31.2		11		11/16	
PLF-3/16-U10	3/16	13	UNF 10/32	26	25.4	5.5	15	7/16	2.5
PLF-3/16-N1			NPT 1/8	30		9		9/16	
PLF-3/16-N2			NPT 1/4	32.5		11		11/16	
PLF-1/4-U10	1/4	13	UNF 10/32	26	25.4	5.5	15	1/2	3.0
PLF-1/4-N1			NPT 1/8	30		9		9/16	4.0
PLF-1/4-N2			NPT 1/4	32.5		11		11/16	4.0
PLF-1/4-N3			NPT 3/8	34		12		7/8	4.0
PLF-5/16-N1	5/16	14.6	NPT 1/8	33.3	30.4	9	18	9/16	6.0
PLF-5/16-N2			NPT 1/4	35.8		11		11/16	
PLF-5/16-N3			NPT 3/8	37.3		12		7/8	
PLF-3/8-N2	3/8	18	NPT 1/4	41.3	36.8	11	22	11/16	7.0
PLF-3/8-N3			NPT 3/8	42.8		12		7/8	
PLF-3/8-N4			NPT 1/2	46.3		15		15/16	
PLF-1/2-N3	1/2	20	NPT 3/8	45.6	39.4	12	22	7/8	9.0
PLF-1/2-N4			NPT 1/2	48.6		15		15/16	

**All Whole Numbers = Millimeter (MM)

Diagram - Female Elbow (PLF)

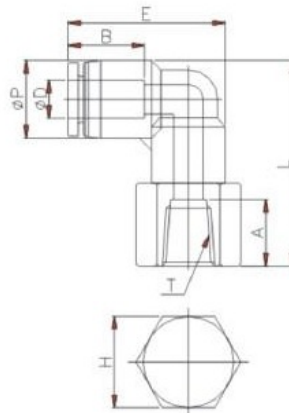

Metric Tube - BSPT Thread Specifications (Refer to Diagram Above)

MODEL	ΦD	T	L	A	B	H	ΦP	ORIFICE
PLF 04-M5	4	M5*P0.8	18.8	5	14.5	9	9	3.2
PLF 04-M6		M6*P1.0	19.8	6		9		3.2
PLF 04-01		PT 1/8	22.8	9		13		3.2
PLF 04-02		PT 1/4	25.8	12		17		3.2
PLF 06-M5	6	M5*P0.8	21	5	15.5	9	11.2	3.5
PLF 06-M6		M6*P1.0	22	6		9		4
PLF 06-01		PT 1/8	25	9		13		4
PLF 06-02		PT 1/4	28	12		17		4
PLF 06-03		PT 3/8	29	13		19		4
PLF 08-01	8	PT 1/8	28	9	17.8	13	13.6	5.5
PLF 08-02		PT 1/4	31	12		17		5.5
PLF 08-03		PT 3/8	32	13		19		5.5
PLF 10-02	10	PT 1/4	33.2	12	19.4	17	16.3	18.5
PLF 10-03		PT 3/8	34.2	13		19		18.5
PLF 10-04		PT 1/2	37.2	16		24		18.5