

Push To Connect Composite Air Fitting- Male Elbow (PL)

Inch Tube - NPT Thread Specifications (Refer to Diagram A Below)

MODEL	ΦD	T	E	L	A	B	H	ΦP	d	ORIFICE
PL 5/32-U10	5/32	UNF 10/32	22.5	26.7	3.5	15	10	11	2.5	2.5
PL 5/32-N1		NPT 1/8	22.5	30.5	8		10		5.5	3.3
PL 5/32-N2		NPT 1/4	23.5	18.7	10		14		8	3.3
PL 5/32-N3		NPT 3/8	23.5	34.1	11		17		10	3.3
PL 3/16-U10	3/16	UNF 10/32	24.5	27.2	3.5	15	10	13	2.5	3.3
PL 3/16-N1		NPT 1/8	24.5	30.8	8		12		5.5	3.3
PL 3/16-N2		NPT 1/4	24.5	33.8	10		12		8	3.3
PL 3/16-N3		NPT 3/8	24.5	34.8	11		17		10	3.3
PL 1/4-U10	1/4	UNF 10/32	29.3	27.9	3.5	15	12	13	2.5	2.5
PL 1/4-N1		NPT 1/8	29.3	31.3	8		12		5.5	4.5
PL 1/4-N2		NPT 1/4	29.3	33.7	10		14		8	4.5
PL 1/4-N3		NPT 3/8	29.3	34.9	11		17		10	4.5
PL 1/4-N4		NPT 1/2	29.3	38.5	14		22		14	4.5
PL 5/16-N1	5/16	NPT 1/8	35.3	35.4	8	18	14	14.4	8	6.6
PL 5/16-N2		NPT 1/4	35.3	37.5	10		14		8	6.6
PL 5/16-N3		NPT 3/8	35.3	38.8	11		17		10	6.6
PL 5/16-N4		NPT 1/2	35.3	42.2	14		21		14	6.6
PL 3/8-N1	3/8	NPT 1/8	37.6	41.8	8	22	17	18.4	8	5.5
PL 3/8-N2		NPT 1/4	37.6	43.8	10		17		8	7.7
PL 3/8-N3		NPT 3/8	37.6	44.8	11		17		8	7.7
PL 3/8-N4		NPT 1/2	37.6	48.3	14		21		14	7.7
PL 1/2-N2	1/2	NPT 1/4	45.5	46.1	10	22	19	21	8	8.8
PL 1/2-N3		NPT 3/8	45.5	48.1	11		19		10	9.9
PL 1/2-N4		NPT 1/2	45.5	50.6	14		21		14	9.9

**All Whole Numbers = Millimeters (MM)

Diagram A - NPT & BSPT Tapered Thread

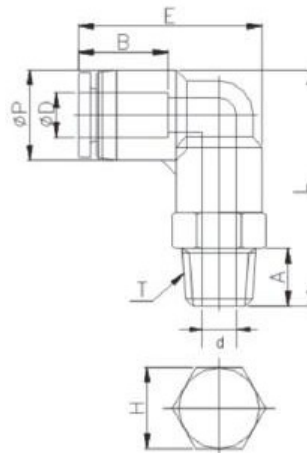

Metric Tube - BSPT Thread Specifications (Refer to Diagram A Above)

MODEL	ΦD	T	E	L	A	B	H	ΦP	d	ORIFICE
PL 04-01	4	PT 1/8	22.5	31.3	8	15	10	11	5.5	2.5
PL 04-02		PT 1/4	23.5	34	10		14		8	2.5
PL 04-03		PT 3/8	23.5	29.5	11		17		10	2.5
PL 04-M5		M5*P0.8	22.5	27.5	3.5		10		2.2	2.5