

Push to Connect Composite Air Fitting - Male Straight (PC)

Inch Tube - NPT Thread Specifications (Refer to Diagram A Below)

MODEL	ΦD	T	L	A	B	H1	H2	ΦP	ORIFICE
PC 5/32-U10	5/32	UNF 10/32	20.2	3.5	15	7/16	2	10	2.5
PC 5/32-N1		NPT 1/8	20.5	8		7/16	3		3.2
PC 5/32-N2		NPT 1/4	19.5	10		9/16	3		3.2
PC 5/32-N3		NPT 3/8	20.5	11		11/16	3		3.2
PC 3/16-U10	3/16	UNF 10/32	22	3.6	15	7/16	2.5	11	2.5
PC 3/16-N1		NPT 1/8	23.1	8.5		7/16	3		3.2
PC 3/16-N2		NPT 1/4	23.1	10.5		9/16	3		3.2
PC 3/16-N3		NPT 3/8	24.1	11.5		11/16	3		3.2
PC 1/4-U10	1/4	UNF 10/32	20.3	3.5	15	1/2	2	11.9	2.5
PC 1/4-N1		NPT 1/8	19.2	8		1/2	4		4
PC 1/4-N2		NPT 1/4	20.7	10		9/16	4		4
PC 1/4-N3		NPT 3/8	20.7	11		11/16	4		4
PC 1/4-N4		NPT 1/2	23.7	14		7/8	4		4
PC 5/16-N1	5/16	NPT 1/8	26.9	8	18	9/16	5	13.9	4.8
PC 5/16-N2		NPT 1/4	25.3	10		9/16	5		6.4
PC 5/16-N3		NPT 3/8	22.5	11		11/16	6		6.4
PC 5/16-N4		NPT 1/2	26.5	14		7/8	6		6.4
PC 3/8-N1	3/8	NPT 1/8	30.5	8	22	11/16	5	16.9	4.8
PC 3/8-N2		NPT 1/4	31.3	10		11/16	6		6.4
PC 3/8-N3		NPT 3/8	28.3	11		11/16	8		7.9
PC 3/8-N4		NPT 1/2	27	14		7/8	8		7.9
PC 1/2-N1	1/2	NPT 1/8	32.4	8	22	19	5	18.8	4.8
PC 1/2-N2		NPT 1/4	34.4	10		19	6		6.4
PC 1/2-N3		NPT 3/8	31.8	11		19	8		9.5
PC 1/2-N4		NPT 1/2	33.3	14		7/8	8		9.5

**All Whole Numbers = Millimeter (MM)

Diagram A - NPT & BSPT Tapered Thread

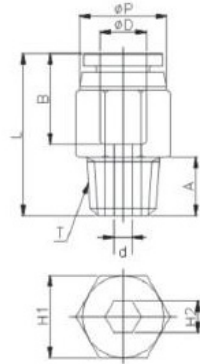

Metric Tube - BSPT Thread Specifications (Refer to Diagram A Above)

MODEL	ΦD	T	L	A	B	H1	H2	ΦP	ORIFICE
PC 04-01	4	PT 1/8	20.7	8	15	10	3	10	3
PC 04-02		PT 1/4	19	10		14	3		3
PC 04-03		PT 3/8	19	11		17	3		3
PC 04-M5		M5*P0.8	20.4	3.5		10	2		2
PC 04-M6		M6*P1.0	20.4	4		10	2		3
PC 06-01	6	PT 1/8	21.5	8	15	12	4	12	4
PC 06-02		PT 1/4	22.9	10		14	4		4
PC 06-03		PT 3/8	21.2	11		17	4		4
PC 06-04		PT 1/2	25	14		21	4		4
PC 06-M5		M5*P0.8	21.8	3.5					