

Push to Connect Composite Air Fitting - Union Straight (PUC)

Inch Tube Specifications (Refer to Diagram Below)

MODEL	ΦD	L	E	C	B	ΦP	ORIFICE
PUC-5/32	5/32	13.5	32.8	3.3	11.4	11	3
PUC-3/16	3/16	13.5	32.8	3.3	11.4	11	5
PUC-1/4	1/4	16	35	3.3	11.9	13	5
PUC-5/16	5/16	17.6	39	3.3	13.3	14.6	6
PUC-3/8	3/8	21.4	48	4.2	16.2	18	8
PUC-1/2	1/2	23.5	50	4.3	17	20	10

**All Whole Numbers = Millimeter (MM)

Diagram Union Straight (PUC)

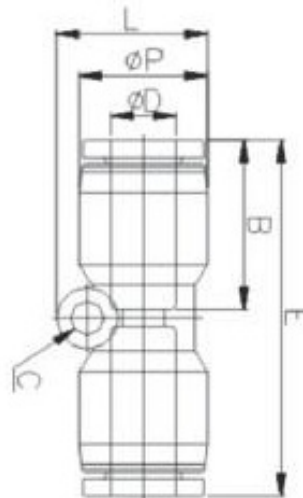

Metric Tube Specifications (Refer to Diagram Above)

MODEL	ΦD	E	C	B	ΦP	ORIFICE
PUC-04	4	32.8	3.3	11.4	11	3
PUC-06	6	35	3.3	11.9	13	5
PUC-08	8	39	3.3	13.3	14.6	6
PUC-10	10	48	4.2	16.2	18	8
PUC-12	12	50	4.3	17	20	10
PUC-16	16	63	4.3	18.6	26	13

**All Whole Numbers = Millimeter (MM)